

STAHL HOUSE

Architect: Pierre Koenig - 1960

Abbey Roskos | Isla Francis | Madison Simboli



THE STAHL HOUSE is located on a small lot in the hills above Los Angeles. Built in 1960 by Pierre Koenig, the motivating force behind the design of the home was the 270-degree view of the city below. The topography drops rapidly on three sides of the site making the house feel as if it is floating on the city below. Floor-to-ceiling windows and a cantilevered base both allow occupants to closely experience the surrounding environment. The aim, which at the time was considered experimental, integrates modernist principles with residential architecture to both functionally and aesthetically represent the lifestyle of the modern age.

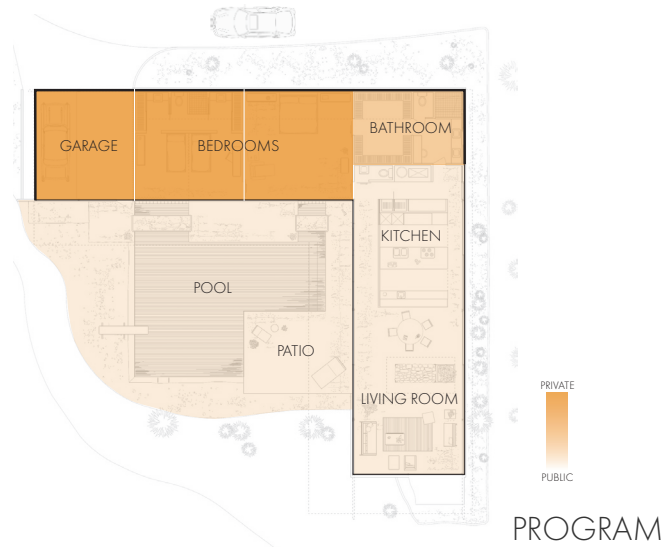

above from: <https://atlasofplaces.com/architecture/stahl-house/>

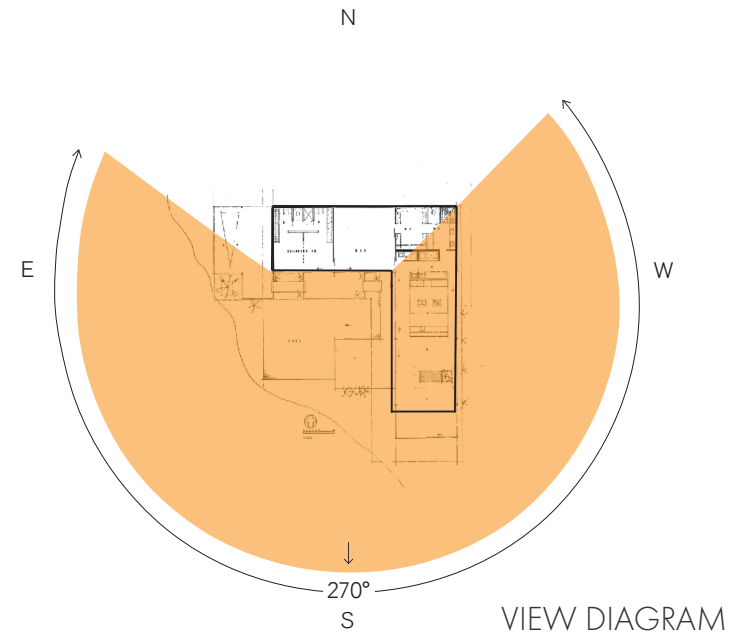

Photographed by Julius Shulman with our annotations.

VIEWS: The floor to ceiling glass windows offer panoramic views of the city below. These views of the LA streets were purposefully designed to align with the steel beam structure of the house.



<https://splaust.wordpress.com/2012/04/05/pierre-koenigs-case-study-house-21/>

PIERRE KOENIG (1925-2004) was an architect based in Southern California who designed Stahl house early in his career. He is known for steel frame structures, using industrial technology, and for economical and environmentally-conscious house design. Natural expression of materials without ornamentation was critical to his architectural success. All of his residential structures use passive cooling and solar heating techniques to create energy efficient buildings.



<http://www.angelonliving.com/blog/stahl-house-case-study-house-22-pierre-koenig-1960>